

Assembly Instruction (15021-885)

Art No.	Description
88888-1258	SP - Arrow armchair - Screw set
88888-1238	SP - Arrow armchair - Black Frame
88888-1236	SP - Arrow armchair - Grey Seat Backrest
88888-1237	SP - Arrow armchair - Grey Seat Cushion

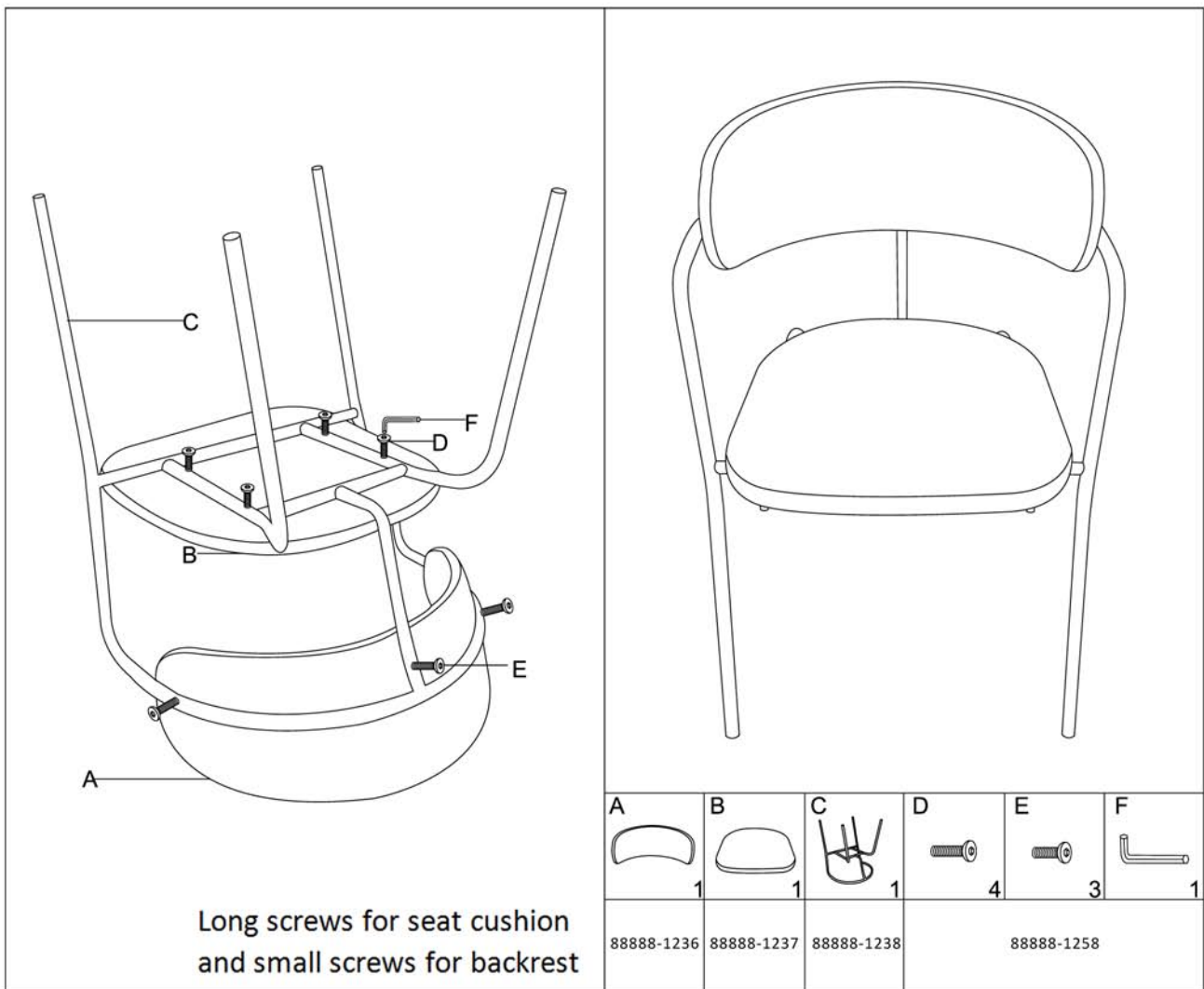

✘ Important Note:

- 1, Start from the middle screw mounting, and tighten the screws 50% then move on to the screws on both sides.
- 2, Try to make the screws match the holes on the backrest, and this may need push a little harder to make the backrest the right place, then tighten the screws 50%.
- 3, At last, get back to the middle screws and tighten all screws fully.

✘ Please make sure that there is no gap between the frame and backrest when make the assembling!